

螺纹刀片 切断切槽刀片

Theading Inserts
Parting & Grooving Inserts

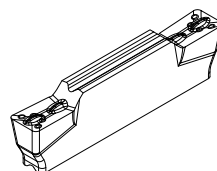
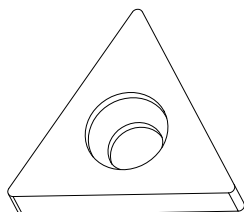
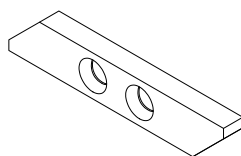
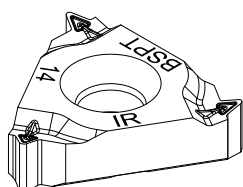

LW

形状 Shape	型号 Type	尺寸 Dimension (mm)				牌号 Brand				
		IC	L	T	D1	GK05	GU10	GU20	GM15	GM25
	LW06	3.97	6.0	1.91	2.30					
	LW08	4.76	8.0	2.38	2.30					
	LW11	6.35	11.0	3.18	3.00			•		
	LW16	9.53	16.0	3.68	4.00			•		
	LW22	12.70	22.0	4.90	4.85			•		
	LW27	15.88	27.0	6.35	6.40					

TNRC

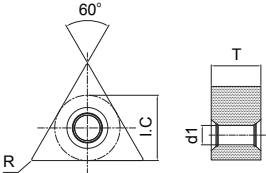
形状 Shape	型号 Type	尺寸 Dimension (mm)				牌号 Brand				
		IC	T	D1	R	GK05	GU10	GU20	GM15	GM25
	TNRC320	9.53	3.18	3.89	0.2			•	•	
	TNRC430	12.70	4.76	5.16	0.2			•	•	
	TNRC540	15.88	6.35	6.40	0.2			•	•	

LW16-S

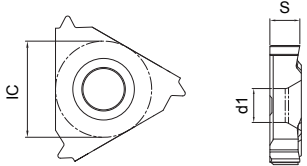
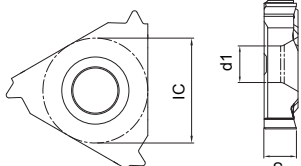
形状 Shape	型号 Type	尺寸 Dimension (mm)			牌号 Brand	
		IC	S	D1	GU20	GM15
	16ERM100	9.53	3.60	4.00	•	
	16ERM150	9.53	3.60	4.00	•	
	16ERM200	9.53	3.60	4.00	•	
	16IRM100	9.53	3.60	4.00	•	
	16IRM150	9.53	3.60	4.00	•	
	16IRM200	9.53	3.60	4.00	•	

LW-BSPT

形状 Shape	型号 Type	尺寸 Dimension (mm)			牌号 Brand	
		IC	S	D1	GU20	GM15
	3IRM11BSPT	9.53	3.60	4.00	•	•
	3IRM14BSPT-MP2	9.53	3.60	4.00	•	•

LWSD

形状 Shape	型号 Type	尺寸 Dimension (mm)			牌号 Brand		
		齿数 Teeth	L	H	T	GP10	
		MT2TBU7551-BLK	2	16.3	16.15	5.49	●
		16CER8APIRD75-3M	3	16.3	15.67	5.59	●
		YX017003	3	17.2	15.08	5.44	●
		YX017004	3	17.2	15.33	5.44	●
		YX017005	3	17.2	15.44	5.44	●
		YX016005	4	16.3	16.64	5.59	●
		YX020007	4	20.8	16.18	5.33	●
		YX025007	5	25.8	16.26	5.59	●
		YX025003	7	25.9	16.51	5.59	●

切断切槽刀片 Parting & Grooving Inserts

MGMN

形状 Shape	型号 Type	尺寸 Dimension (mm)					牌号 Brand			
		B	R	L	D	T	GK05	GU20	GU25UF	GM15
	MGMN150-M	1.50	0.20	16.00	1.20	3.50				
	MGMN200-M	2.00	0.20	16.00	1.60	3.50				•
	MGMN250-M	2.50	0.20	18.50	2.00	3.85				•
	MGMN300-M	3.00	0.40	21.00	2.35	4.80				•
	MGMN400-M	4.00	0.40	21.00	3.30	4.80				•
	MGMN500-M	5.00	0.80	26.00	4.10	5.80				•
	MGMN600-M	6.00	0.80	26.00	5.00	5.80				•

GKF

形状 Shape	型号 Type	尺寸 Dimension (mm)					牌号 Brand		
		IC	T	H	L	D1	GU20	GU25UF	GM15
	GKF12R	8.70	3.0	8.70	22.5	5.00		•	
	GKF12L	8.70	3.0	8.70	22.5	5.00			
	GKF16R	9.50	4.0	9.50	27.0	5.00		•	
	GKF16L	9.50	4.0	9.50	27.0	5.00			

GCP

形状 Shape	型号 Type	尺寸 Dimension (mm)					牌号 Brand		
		IC	T	H	L	D1	GU20	GU25UF	GM15
	GCP12R	8.00	2.5	8.00	20.00	4.40		•	
	GCP12L	8.00	2.5	8.00	20.00	4.40			
	GCA16R	9.40	3.5	9.40	25.00	5.00		•	
	GCA16L	9.40	3.5	9.40	25.00	5.00			

GF

形状 Shape	型号 Type	尺寸 Dimension (mm)						牌号 Brand	
		IC	T	H	L	D1 I	I	GU25UF	GM15
	GF038001	8.40	4.00	8.40	38.5	4.60	11.50	•	
	GF043001	8.40	4.80	8.40	43.5	4.30	10.00	•	

TOP-NOTCH

形状 Shape	型号 Type	尺寸 Dimension (mm)				牌号 Brand				
		L1	L	W	T	GK05	GU10	GU20	GM15	GM25
	KNMR1104R	9.30	14.43	5.94	4.19		•			
	KNMR1104L	9.30	14.43	5.94	4.19		•			
	KNMR2005R	16.74	24.26	9.19	5.33	•	•	•		
	KNMR2005L	16.74	24.26	9.19	5.33	•	•	•		
	KNMR2406R	19.94	29.90	12.01	6.93	•	•			
	KNMR2406L	19.94	29.88	12.01	6.93	•	•			
	KNMR2410R	19.81	29.78	12.01	10.16		•			
	KNMR2410L	19.81	29.78	12.01	10.16		•			
	KNMR3510R	27.94	41.61	17.86	10.16	•	•	•		•
	KNMR3510L	27.94	41.61	17.86	10.16		•			•
	KNMR3513R	27.94	41.61	17.86	13.00			•	•	
	KNMR3513L	27.94	41.61	17.86	13.00					